

# Internal Freewheels FZ ... 2RS

for press fit on the outer ring  
with sprags, bearing support and sealing

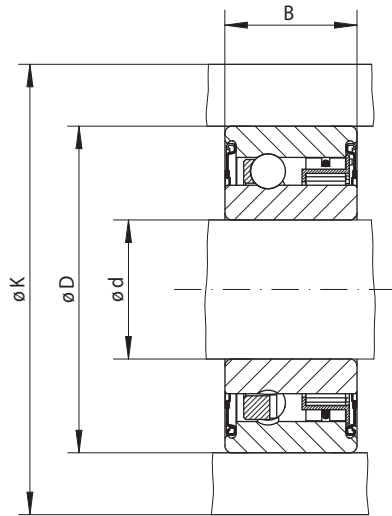

4-1

Indexing Freewheel Overrunning Clutch Backstop	Standard type For universal use	Dimensions

Freewheel Size	Nominal torque $M_N$ Nm	Maximum speed $n$ $\text{min}^{-1}$	Load rating of bearing support		Bore $d$ mm	$B^*$ mm	$D$ mm	$K$ mm	Weight kg
			dynamic $C$ N	static $C_0$ N					
FZ 6201 2RS	9	10 000	5 140	2 370	12	14	32	39	0,05
FZ 6202 2RS	21	8 400	5 160	2 410	15	16	35	42	0,07
FZ 6203 2RS	32	7 300	5 650	2 860	17	17	40	51	0,09
FZ 6204 2RS	88	6 000	6 890	4 190	20	19	47	58	0,15
FZ 6205 2RS	100	5 200	7 230	4 660	25	20	52	63	0,18
FZ 6206 2RS	230	4 000	7 730	5 660	30	21	62	73	0,27
FZ 6207 2RS	330	3 600	8 170	6 630	35	22	72	85	0,40
FZ 6208 2RS	420	3 000	8 950	7 990	40	27	80	94	0,60

■ Freewheels with bore diameters highlighted blue in the table are available with short delivery times.

The maximum transmissible torque is 2 times the specified nominal torque. See page 14 catalogue „Freewheels“ for determination of selection torque.

\* The width of freewheel size from FZ 6201 2RS to FZ 6208 2RS is different to the corresponding ball bearings of series 62.

## Mounting

The torque is transmitted on the inner and outer ring by press fit. In order to transmit the torques specified in the table, the outer ring must be accommodated in a housing with an external diameter  $K$ . The housing is made of steel or grey cast iron in minimum quality GG-20. When using other housing materials or smaller external diameters, we urge you to contact us regarding the transmissible torque.

The tolerance of the housing bore  $D$  must be ISO N6 and the tolerance of the shaft must be ISO n6.

The permissible operating temperature of the freewheel is  $-20\text{ }^\circ\text{C}$  to  $+80\text{ }^\circ\text{C}$ . Please contact us if the temperature is different to the given values.

## Lubrication

The freewheels are supplied grease-filled and with 2 RS seals.

## Example for ordering

Freewheel size FZ 6203 2RS, standard type:

- FZ 6203 2RS

# Internal Freewheels FZ ... P2RS

for press fit on the outer ring  
with sprags, bearing support and sealing

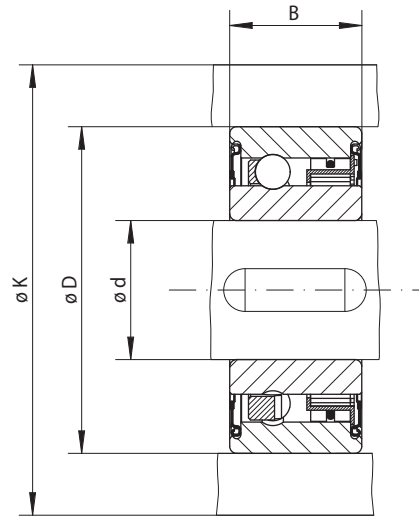

5-1

Standard type For universal use			Dimensions							
Freewheel Size	Nominal torque $M_N$ Nm	Maximum speed $n$ $\text{min}^{-1}$	Load rating of bearing support		Bore $d$ mm	$B^*$ mm	$D$ mm	$K$ mm	Weight kg	
			dynamic $C$ N	static $C_0$ N						
FZ 6201 P2RS	9	10 000	5 140	2 370	12	14	32	39	0,05	
FZ 6202 P2RS	21	8 400	5 160	2 410	15	16	35	42	0,07	
FZ 6203 P2RS	32	7 300	5 650	2 860	17	17	40	51	0,09	
FZ 6204 P2RS	88	6 000	6 890	4 190	20	19	47	58	0,15	
FZ 6205 P2RS	100	5 200	7 230	4 660	25	20	52	63	0,18	
FZ 6206 P2RS	230	4 000	7 730	5 660	30	21	62	73	0,30	
FZ 6207 P2RS	330	3 600	8 170	6 630	35	22	72	85	0,40	
FZ 6208 P2RS	420	3 000	8 950	7 990	40	27	80	94	0,60	

■ Freewheels with bore diameters highlighted blue in the table are available with short delivery times.  
The maximum transmissible torque is 2 times the specified nominal torque. See page 14 catalogue „Freewheels“ for determination of selection torque.  
Keyway according to DIN 6885, page 3 • Tolerance of keyway width JS10.  
\* The width of freewheel size from FZ 6201 P2RS to FZ 6208 P2RS is different to the corresponding ball bearings of series 62.

## Mounting

The torque is transmitted on the inner ring by keyway connection and on the outer ring by press fit. In order to transmit the torques specified in the table, the outer ring must be accommodated in a housing with an external diameter  $K$ . The housing is made of steel or grey cast iron in minimum quality GG-20. When using other housing materials or smaller external diameters, we urge you to contact us regarding the transmissible torque.

The tolerance of the housing bore  $D$  must be ISO N6 and the tolerance of the shaft must be ISO k6.

The permissible operating temperature of the freewheel is  $-20\text{ }^{\circ}\text{C}$  to  $+80\text{ }^{\circ}\text{C}$ . Please contact us if the temperature is different to the given values.

## Lubrication

The freewheels are supplied grease-filled and with 2 RS seals.

## Example for ordering

Freewheel size FZ 6205 P2RS, standard type:  
• FZ 6205 P2RS

**Morskate®**



Any questions? Please contact us.

**Morskate Aandrijvingen BV**

Oosterveldsingel 47A  
7558 PJ Hengelo (Ov)  
The Netherlands

NL

T +31 (0)74 - 760 11 11  
info@morskateaandrijvingen.nl  
www.morskateaandrijvingen.nl

DE

T +49 692 - 222 34 95  
info@morskateantriebstechnik.de  
www.morskateantriebstechnik.de

EN

T +31 (0)74 - 760 11 11  
info@morskatedrivetechnology.com  
www.morskatedrivetechnology.com